



The  
Scientific  
Group



# VET PORTFOLIO



BECAUSE **ALL LIVES** MATTER...

Tel: +27 11 568 9047 | Email: [sales@scientificgroup.com](mailto:sales@scientificgroup.com)

## HORIBA

Microsemi CRP: · CBC+CRP results in 4 minutes (15 tests /

hour)

- CBC results in 1 minute (55 tests / hour)
- Whole blood Micro-Sampling CBC: 10µL / CBC+CRP: 18µL

### Yumizen H550

Hematology Solutions for Small-Mid Laboratories

Closed Tube System Open Tube System

- CBC/Diff Analysis
- 2 Reagents Use
- 37 Parameters Menu

### Auto Loader System

- Integrated Auto Sample
- Positive Identification
- 40 Tube Continuous Loading



Microsemi CRP



Yumizen Closed Tube System



Yumizen Open Tube system



Yumizen Open Tube system

## LOCMEDT

Chemistry Analyzer: 8 Parameters (3 drops of blood)

### Comprehensive Diagnostic Panel 22

- ALB; AST; ALT; AMY; ALP; CK; CRE; Glu; Phos; LDH; GGT; CA; TBIL; TC; TG; TP; UA; BUN; Glob; Bun/Creat; AST/ALT; A/G

### Critical Care Panel

- ALT; Amy; CHE; Cre; NH3; Glu; Na+; K+; Bun; Na/K+; TCO2; BUN/CREAT; CL

### Liver Function Panel 13

- ALB; AST; ALT; ALP; GGT; TBA; Tbil; TC; TP; UA; Glob; A/G; AST/ALT

### Kidney Function Panel 9

- ALB; Phos; Bun; UA; CA; K+; tCO2; Bun/Creat

### Liver Function & Kidney Function Panel 1

- ALB; AST; ALT; ALP; CREAT; Glu; GGT; TBIL; TP; BUN; Glob; A/G; BUN/CREAT; AST/ALT

### Electrolyte Panel 9

- K+; NA+; Cl-; tCO2; Ca; Mg2+; PHOS; PH; NA+/K+

### Preanesthetic Panel 11

- AST; ALT; ALP; CK; CREAT; GLU; LDH; TP; BUN; Bun/Creat; AST/ALT

### Health Check Panel 16

- TP; ALB; CK; A/G; TBIL; ALT; BUN; CREAT; GLU; TC; CA; PHOS; GLOB; AMY; ALP; BUN/CREAT



# Getein

Veterinary Diagnostics:



## CM-50 Vet Clinical Chemistry Analyzer

Intelligent Detection for Longer Pet Companionship

- 100  $\mu$ L microvolume sampling, small animals friendly
- A variety of check-up packages one sample, multiple indicators
- Portable and compact appearance, meet the needs of animal hospitals
- With professional intelligent quality control system to guarantee the accuracy of results

### Test Menu:

#### 10 Biochemistry Parameters

*ALB, TP, ALT, Crea, BUN, GLU, ALP Bun/Crea, GLOB, ALB/GLOB*

#### 10 Pre-op Parameters

*ALT, ALP, TP, CK, AST, LDH, GLU, Crea, BUN, Bun/Crea*

#### 16 Health Check Parameters

*ALT, AST, TB, TP, ALB, GLOB, ALB/GLOB, Glu, AMY, Crea, Bun, Bun/Crea, Ca, PHOS, CK, TG*

#### 24 Comprehensive Parameters

*ALT, AST, GGT, TBA, TB, ALP, TP, ALB, GLOB, ALB/GLOB, GLU, AMY, LPS, Crea, BUN, Bun/Crea, Ca, UA, PHOS, CK, LDH, TC, TG, tCq<sub>2</sub>*



## Getein 1100 Vet Immunofluorescence Quantitative Analyzer

Better Care for Your Beloved Pets

- Provide high-quality testing, Advanced immunofluorescence quantitative technology
- Get results in 3-15 min
- Support WIFI, convenient data transmission, free of network cables
- Small in size, lithium-ion battery (optional)
- Large display, Android system, user-friendly interface

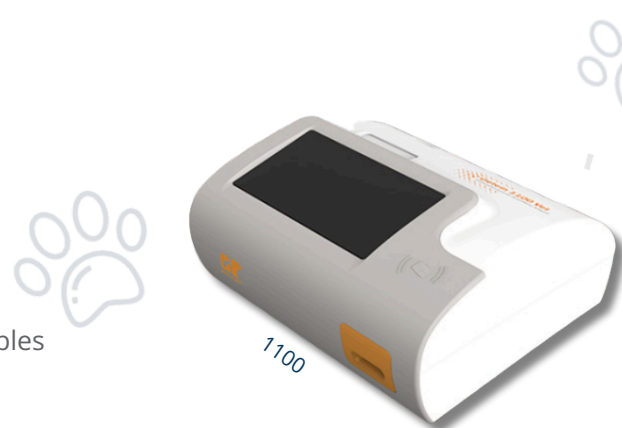

## Getein 1160 Vet Immunofluorescence Quantitative Analyzer

- Multi-channel, 4 incubation channels for saving operation time
- Support WIFI connection to the Ani-Q system for printing A4 report sheets
- RFID cards, with automatic input of test strip information
- Provide a constant testing temperature at 32°C to ensure accurate results



### Test Menu for all Immunofluorescence Quantitative Analyzers :

#### Infectious Disease (Antigen)

*FPV Ag, FCov Ag, FHV Ag, FCV Ag, CDV Ag, CCVAE, CPV Ag, CPV Ag/CCV Ag*

#### Infectious Disease (Antibody)

*FPV Ab/FHV Ab/FCV Ab, CPV Ab/CDV Ab/CH Ab*

#### Cardiac Markers

*cTnI, CNT-proBNP, fTnI, fNT-proBNP*

#### Inflammation

*cCRP, fSAA*

#### Hormone

*cProg, CCortisol, cTSH, T4*

#### Pancreatic Markers

*cPL, fPL*



# Pluslife



Pet Diagnosis:

## Dock Pro 8 - PM008P

Eight-Channel POC Molecular Analyzer

Features:

- 8 test channels work independently
- Reagent: free from cold-chain
- Benchtop size and stackable
- 7" touchscreen with intuitive control
- Support LIS system
- Barcode scanner and result printer available



PM008P

## MiniDock - PM003/PM003 Ultra

Rapid Molecular POCT System

Features:

- Palm-sized, weight: 240g
- Reagent: free from cold-chain
- Support LIS system and multiple output of result
- Universal Charging Solution: power bank compatible
- Built-in barcode scanner (*PM003 Ultra Only*)
- Document Storage Capacity: 6,000 files (*PM003 Ultra Only*)
- Wi-Fi Connectivity Available (*PM003 Ultra Only*)



PM003 / PM003 Ultra

## Nucleic Acid test cards

- FCV/FHV-1/M. felis/C. felis/Bb
- FeLV/FIV
- Haemotropic Mycoplasma
- Leishmania spp.
- Giardia/Tritrichomonas foetus
- CDV/CPIV/CAV-2/Bb
- FPV/CPV
- Babesia spp.
- Anaplasma/Ehrlichia
- Dirofilaria repens/immitis



Instrument

Immunofluorescence Assay

Features:

- Easy to use, only one step is needed before reading the result.
- Fast, Result reported in 3-12 mins.
- Good performance with high sensitivity.
- Battery/Power supply, Indoor/Outdoor use.



Immunofluorescence Assay

DNP provides two kinds of detection kits, safeguarding pets' health:

- Immunofluorescent detection kit (with analyzer)
- Colloidal gold detection kit (without analyzer)

Immunofluorescence test items :

Canine tests

cCRP, CPV-Ag, CDV-Ag, CCV-Ag, CPV-Ab, CDV-Ab, CAV-Ab, cLSH-Ab, cTOXO-Ab, cPL, cNT-proBNP, cTT4, cTSH, cCortisol, cProg, cRLN, cCyC

Feline tests

fSAA, FPV-Ag, FHV-Ag, FCV-Ag, FCoV-Ag, FeLV-Ag, FPV-Ab, FHV-Ab, FCV-Ab, FIV-Ab, fPL, fNT-proBNP, fTT4, fCyC



Other Animal tests

Giardia Antigen Rapid Test  
Toxoplasma IgG/IgM Antibody Rapid Test

PRIMA VETERINARY

KI SCREENING TEST Canine NGAL Detection

The first and only rapid test for semi-quantitative detection of NGAL in urine for early screening of kidney damage in dogs

Principle of the Test:

KI SCREENING TEST is a lateral flow immunochromatographic device, for veterinary use, for semi-quantitative detection of NGAL in dog urine samples.

Who are the intended users:

The device is intended to be used by healthcare professionals in order to quickly determine the concentration of NGAL in dog urine, which is directly proportional to the severity of kidney damage and indicative of potential clinical settings.

Analytical Performances:

- Sensitivity 99,21%
- Specificity 98,15%
- Accuracy 98,90%



For professional in-vitro diagnostic use only

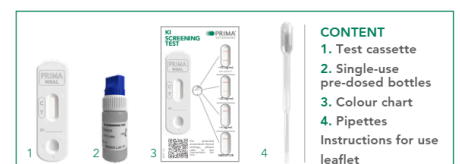
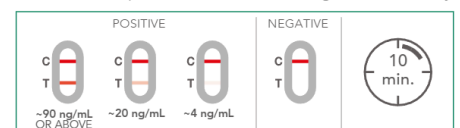

# Nova Biomedical



## Blood Gas Analysers: Prime Plus VET & Prime CC Comp VET

Stat Profile Prime Plus VET is a comprehensive, whole blood critical care analyzer that combines blood gases, electrolytes, metabolites, co-oximetry, and 32 calculated results in a simple, compact analyzer.

Prime Plus VET combines maintenance-free, replaceable cartridge technology for sensors & reagents with patented, new, maintenance-free & non-lysing whole blood co-oximetry technology.

Reference ranges can be set up per animal species.

Prime Plus VET: 22 measured parameters

- PO2, PCO2, pH, Hct, tHb, Na, Cl,
- K, TCO2, iCa, iMg, Glu, Lac, BUN,
- Creat, SO2%, COHb, O2HB,
- MetHb, HHb, SHb, Tbili, FHb.



### **For animal use only. Not for human application- Blood Gas**

Nova VET provides rapid, quantitative blood ketone and glucose testing to support metabolic assessment in both dairy cattle and companion animals.

Using only a tiny blood sample, the system delivers lab-comparable BHB accuracy within the clinically significant subclinical range for early lactation cows, while also supporting the evaluation of diabetic ketoacidosis (DKA) risk in cats and dogs.

Results are available in seconds, enabling earlier intervention, informed clinical decision-making, and improved outcomes across veterinary herd management and companion animal care.



### Hand Held Meters:

StatStrip Meters available for:

- Glucose
- Glucose & Ketone
- Creatinine
- Lactate
- Lactate, Hb & Hct
- Creatinine & EGFR



StatStrip Glucose



StatStrip Glucose & Ketone



StatStrip Creatinine



### Xpress meters:

- Glucose
- Glucose & Ketone
- Creatinine
- Lactate
- Lactate, Hb & Hct



StatStrip Lactate



StatStrip LAC-Hb-Hct



Nova Max Pro Creat eGFR





# Capricorn Biomedical

## Blood Gas Syringes

Single Use syringes for Arterial Blood gas determination.

- Each Syringe packaged in peel away pouch.
- Sterile (EO)
- Syringes are coated with dry electrolyte balanced (CA+++)  
lyophilized Heparin (USP)



in the following concentrations:

- I) 1 ml – 30 IU Li Hep
- II) 2ml – 50 IU Li Hep
- III) 3ml – 80 IU LI Hep



## Blood Gas Syringes with needle

Single Use syringes for Arterial Blood gas determination.

- Each Syringe packaged in peel away pouch.
- Sterile (EO)
- Syringes are coated with dry electrolyte balanced (CA+++)  
lyophilized Heparin (USP)



in the following concentrations:

- I) 1 ml – 30 IU Li Hep
- II) 2ml – 50 IU Li Hep
- III) 3ml – 80 IU LI Hep



# KW Tecnilabo



KW is a leading innovator in controlled temperature equipment, specializing in ultra-low temperature devices down to -90°C. Known for reliability, flexibility, and customization, KW combines strong scientific expertise with certified medical device standards. As a trusted partner, they provide high-quality temperature solutions for our veterinary portfolio.



## COLD LINE REFRIGERATORS & FREEZERS

## PLASMA SHOCK FREEZERS



KBPR NG - UNDER THE COUNTER



KLAB R



WITH AUTOMATIC DEFROST (KLAB F)



VERTICAL STRUCTURE (KPFV V)

## VWR

- Analytical Balance
- Semi-micro Balance
- Precision Balance
- Moisture Balance
- Calibration Weights



**avantor™**  
delivered by **VWR™**

## NYZtech

NYZtech provides a vast range of qPCR Kits for the veterinary, food, and pharmaceutical industries. At NYZtech we understand the unique challenges faced by these industries, and our qPCR Kits are specifically designed to meet those needs. Our Kits offer exceptional sensitivity and specificity,

Our products allow the improvement of health and well-being of animals, and ensure the safety and quality of consumer goods. In veterinary medicine, qPCR testing plays a critical role in the diagnosis and surveillance of infectious diseases in animals.

**NYZtech**  
genes & enzymes



## HORIBA

### Yumivet VH2500

### Veterinary Hematology Analyzer

The Yumivet VH2500 is a high-end analyzer tailored for veterinary clinical and operational needs, ensuring precise results.

- Real High Throughput Capacity
- UP to 57 Parameters
- Multi-species
- Continuous Workflow

**HORIBA**



## Invitek Diagnostics

### Molecular Diagnostics

### Animal Health

#### Pathogen PCR detection in animals

Nucleic acid targeted analysis emerges as a robust and sensitive tool for the detection of various pathogens that impact poultry and livestock production. Invitek Diagnostics offers a comprehensive and increasing range of InviScreen® diagnostic kits for farm animals that target bacterial and viral pathogens.

- InviScreen® Bovine Viral Diarrhea Virus Detection Kit -
- InviScreen® Infectious Bronchitis Virus Detection kit -
- InviScreen® Infectious Brusal Disease Virus Detection kit -
- InviScreen® Mycoplasma (Mg/Ms) Detection Kit -

#### DNA/RNA extraction from veterinary pathogens

- InviSorb® Spin Universal Kit
- RTP® Pathogen Kit
- InviSorb® Spin Tissue Mini Kit

**INVITEK**  
diagnostics





## Centrifuges

- Digicen 22



- Max. Speed** 26.480 xg / 16.500 RPM
- Version** Refrigerated
- Max. Capacity** 4 x 125 ml
- Screen Type** TFT
- Max. Volume** 500 ml

- Unicen 21



- Max. Speed** 2.938 xg / 4.200 RPM
- Version** Ventilated
- Max. Capacity** 4 x 100 ml
- Screen Type** LED
- Max. volume** 480 ml



- Plasma 22

- Max. Capacity** 8 x 9/15 ml
- Max. Speed** 1.288 xg / 3.000 RPM
- Screen Type** LCD
- Version** Ventilated



## Distillers



- Automatic distillers of continuous production and with water flow control
- Stainless steel for the inner and the inner heater, stainless steel painted with epoxy for housing.
- Reduced size.
- Easily removable for its cleaning.
- High quality of distillation: obtains water of types III and IV (laboratory degree water)
- Conductivity at 20°C: 1,5 microsiemens/ cm.
- Resistivity at 20°C: 0,67 megaohms/ cm.
- PH outcoming water between 5-8 (DA 006) at 25° C.

## Elektronika

### Urine Chemistry & Urine Sediment Analysis

Fully Automated & Semi-Automated



Urised Mini -  
Urine Sediment Analysis

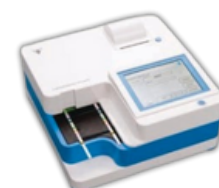

LabUreader -  
Urine Dipstick Analysis





# Feather Blades

- Histology blades & Biopsy Punches
- Industrial Blades
- Ophthalmology Blades
- Dental Blades
- Surgical Blades
- Microsurgery Blades

Trimming knife handles and blades

Main Features:

- The handle is autoclavable, (except F-80mini & F-80HL)
- An ideal trimming knife, with a sharp edge for cutting tissue without causing deformation
- The securely-fitted blade can be easily attached and removed

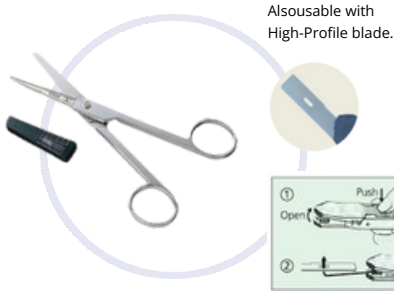
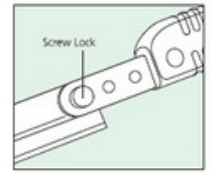

Also usable with High-Profile blade.



Product No.	Inner Diameter	Package
FBP-15	1.5mm	20pcs per Box
FBP-30	3mm	
FBP-40	4mm	
FBP-50	5mm	
FBP-60	6mm	
Actual size		

K-5100		Blade thickness: 0.25mm	
K-5110		Blade thickness: 0.25mm	
K-5200		Depth controller both side Blade thickness: 0.25mm at 2.0mm	
K-5210		Depth controller one side Blade thickness: 0.25mm at 2.0mm	
K-5300		Blade thickness: 0.38mm Angle: 30°	
K-5310		Blade thickness: 0.38mm Angle: 25°	
K-5400		Blade thickness: 0.38mm	
K-5410		Blade thickness: 0.38mm	
K-5411		Blade thickness: 0.38mm	

Pushed Box of 5 blades

K-5500		Blade thickness: 0.38mm	
K-5510		Blade thickness: 0.38mm	
K-5520		Blade thickness: 0.38mm	
K-5600		Blade thickness: 0.38mm	
K-5610		Blade thickness: 0.38mm Saw toothed on one face	

K-18R		Blade thickness: 0.6mm 1.8mm	
K-15R		Blade thickness: 0.6mm 1.5mm	
K-15L		Blade thickness: 0.6mm 1.5mm	
K-12R		Blade thickness: 0.6mm 1.2mm	
K-12L		Blade thickness: 0.6mm 1.2mm	
K-30		Blade thickness: 0.6mm 1.5mm	
K-505		Blade thickness: 0.6mm 2.8mm 19mm	

	Stainless steel blade	Carbon steel blade
10		
11		
12		
12d		
14		
15		
15s		
15c		

	Stainless steel blade	Carbon steel blade
20		
21		
22		
23		
24		
25		

# Sakura



## VIP 6AI Tissue Processor

Advanced, gentle reagent agitation with 10 mixing modes ensures optimal tissue processing. Dual 10.4L bulk reservoirs with automatic onboard mixing save time, improve dehydration and defatting, and reduce human error.

Smart solution management monitors reagent levels, enables automatic solution transfer, and simplifies safe paraffin disposal. Built-in bottle checks and advanced fluid sensors prevent errors before runs begin.

Enhanced safety includes a fume control system, automatic paraffin degassing, heated components to prevent condensation, and ergonomic safety locks.

User-friendly design features a high-resolution touch screen, LED-lit cabinet, color-coded ports, flexible cassette capacity (150–300), up to 50 programmable protocols, customizable cleaning cycles, password protection, and optional xylene-free processing.



## Tissue-Tek® TEC™ 6 Embedder

A trusted choice for decades, the TEC™ 6 continues Sakura's legacy of reliability and ease-of-use.

This robust, ergonomic, and modular embedding system is designed for laboratories of any size, offering a streamlined, adjustable workflow for maximum comfort and efficiency.

## Accu-Cut® SRM™ 500 Rotary Microtome

Designed to support you in producing consistently high-quality sections, this fully manual microtome serves as a reliable partner in microtomy for your lab.

The SRM 500 is equipped with a variety of features to bring you control over your microtomy workload.



- Access high-quality sections & high throughput
- Flexibility at your fingertips
- Your partner in safety
- Sleek in a sweep of a brush



The Capricorn Histology cassettes are tailor made to ensure samples are processed efficiently and securely.

Made from High grade chemically resistant resin.



Cat Number:	Description:	Pack Size
<b>CAP/1000W</b> 	<b>Biopsy Embedding cassette with lids</b>  1mm <sup>2</sup> fine pores for optimal fluid exchange during processing cycle.  Available in: White, Pink, Grey, Blue, Lilac, Orange, Green, Red, Aqua and Yellow	1000/Pack
<b>CAP/1001W</b> 	<b>Uni-cassettes Embedding with lids</b>  1.5 mm holes for optimal exchange of fluid with larger specimens (34 Holes)  Available in: White, Pink, Grey, Blue, Lilac, Orange, Green, Red, Aqua and Yellow	1000/pack
<b>CAP/1002W</b> 	<b>Processing and embedding cassettes</b>  0.5 mm slats for optimal exchange of fluid with larger specimens (56 slats)  Available in: White, Pink, Grey, Blue, Lilac, Orange, Green, Red, Aqua and Yellow	1000/Pack



## Tools & Carbide Plastics

# TCP

- Specimen Jars: 35ml, 40ml & 150ml
- Scoop Jars: 35ml & 40ml
- Test Tube Covers: 16mm & 20mm
- Cotton Swabs: Plastic & Wood Shaft
- Oropharyngeal Swabs: Cotton & Rayon
- Nasopharyngeal Flock Swabs

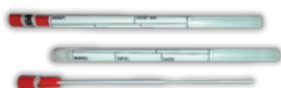

**Laboratory Consumables - Plasticware and Glassware**

- Pipettes and Pipette Tips: Manual and Automation
- Microplates: Multiple Well
- Tubes: Centrifuge, PCR, Cryogenic, Barcoded
- Petri Dishes
- Cell Culture Flasks and Media
- Tubes: Centrifuge and Microcentrifuge
- Storage Bottles: Glass and Plastic
- Sample Containers
- Cryogenic Storage
- Filtration: Vacuum Flask, Syringe Filters, Cell Strainers
- PCR Solutions: Tubes, Plates, Sealing Film



**Laboratory Equipment - General Benchtop**

- Vortex, Shakers, Rotators, Rockers and Mixers
- Pipettes and Bottle Top Dispensers
- Mini Centrifuges
- Incubators, Dry bath heater, Incubators, Waterbaths, Hotplate Stirrers
- Electrophoresis units, Thermal cycler, Sealing Film, Geldoc systems



SG Vac



- Blood Collection Tubes: EDTA, Citrate, Plasma, ESR , SST, Plain Serum, Glucose, Speciality
- Microtainer Tubes
- Blood Collection Needles: Safety needles, Safety Butterfly Needles
- Lancets : 21G to 30G
- Blood Collection Accessories: Holders, Quick Release Holders, Paediatric Tourniquets
- Disposable Waste Containers
- Nasal Swabs



**Platelet Rich Plasma tubes:**

The Platelet Rich Plasma (PRP) tubes is designed to be used for preparation of autologous platelet rich plasma from a small sample of peripheral blood for mixing with autograft and/or allograft bone prior to application to a bony defect for improving handling characteristics.





**The  
Scientific  
Group**

For further product information, please contact your nearest representative:

**HEAD OFFICE GAUTENG / AFRICA SALES**

**Stand 208 • c/o Malibongwe Drive & Epsom Avenue • Boundary Park  
Hoogland Ext 44 • Northriding 2162 • Gauteng • South Africa  
T: +27 11 568 9047 (Head Office and 24/7 Technical Service Hotline)  
E: sales@scientificgroup.com / technical@scientificgroup.com**

**WESTERN CAPE BRANCH**

**First Floor • Tijger Park 5 • Belville Park • Cape Town 7530  
T: +27 11 568 9047**

**BLOEMFONTEIN BRANCH**

**47 President Steyn Street • Westdene • Bloemfontein 9301  
T: +27 11 568 9047**

**KZN / EASTERN CAPE BRANCH**

**Island Office Park • 35/37 Island Circle • Block 4 • Ground Floor  
Riverhorse Valley • Durban 4001**



<https://www.scientificgroup.co.za/>